

Digital Cabinets Roll-Through Compact Refrigerator 750 lt - 1 Full, 1 Glass door

ITEM # _____

MODEL # _____

NAME # _____

SIS # _____

AIA # _____

726654 (RI075R2FGT)

Roll-Through Compact Refrigerator 750 lt - 1 full door, 1 glass door- 230 V/1N/50Hz

Short Form Specification

Item No.

External and internal in AISI 304 stainless steel. Insulation thickness mm60. One right hinged full door and one glass door with lock. Bottom door gasket adjustable. Built-in refrigeration unit; ventilated operating mode; digital control; evaporator; automatic defrost; external digital temperature display; high/low humidity switch; internal lighting. Operating temperature +2+10°C. For ambient temperatures up to 32 °C. CFC and HCFC free. R134a gas in refrigeration circuit. Gas in foam: Cyclopentane.

Main Features

- Excellent space optimisation thanks to the compact dimensions (footprint 0.56m²).
- One right hinged full door and one glass door with lock.
- The operating temperature can be adjusted from +2 to +10°C to suit both meat and dairy storage requirements.
- Performance guaranteed at ambient temperatures of +32°C.
- Simple control panel: on/off switch, high/low humidity switch and digital temperature display.
- Automatic defrost and automatic evaporation of defrost water.
- Ventilated cooling for optimal temperature distribution.
- Simple cooling unit easily accessible from the rear of the appliance.
- Universal shock-protectors on all sides.
- Suitable for all kinds of 18 shelves GN 1/1 trolleys, designed to fit the 18 shelves GN 2/1 trolley available as optional accessory.
- Adjustable bottom door gasket.
- Lift-up control panel to better access main components.
- Connectivity ready for real time access to connected appliances from remote and data monitoring (requires optional accessory).

Construction

- Built-in compressor to suit operating conditions.
- Interior cell and external panel are constructed in 304 AISI stainless steel.
- Refrigerant type: R134a.
- Developed and produced in ISO 9001 and ISO 14001 certified factory.
- Cabinet fitted with up to 60 mm thickness of Cyclopentane insulation for best insulating performance (thermal conductivity: 0,020 W/m*K). CFC and HCFC-free insulation.

Optional Accessories

- Trolley 18x2/1GN for roll-in 750lt PNC 881521

APPROVAL: _____

Front

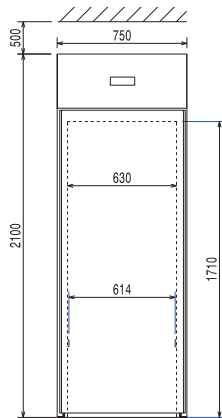

Side

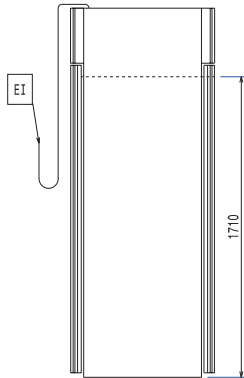

EI = Electrical inlet (power)

Top

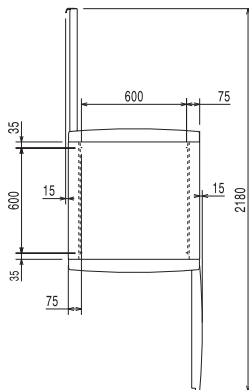

Electric

Supply voltage:

726654 (R1075R2FGT) 230 V/1 ph/50 Hz

Key Information:

Door hinges:	Right Side
External dimensions, Width:	750 mm
External dimensions, Height:	2100 mm
Number and type of doors:	2 Full;Glass
External side panels:	304 AISI
External top panels:	304 AISI
External door material:	Glass
Internal panels material:	304 AISI

Refrigeration Data

Compressor power:	3/8 hp
Refrigerant type:	R134a
Refrigeration power:	645 W
Refrigerant weight:	260 g
Operating temperature min.:	2 °C
Operating temperature max.:	10 °C